

We reserve the right to revise the design or components of any product without notice.

Sabre Series

Wall, Ceiling or Pendant Mount
Fully Dimmable LED Luminaire
INDOOR

CATALOG #		TYPE
PROJECT/LOCATION		
APPROVED BY		

SPECIFICATIONS

- Housing: Extruded aluminum houses all wiring and components for ease of installation.
- Optional reflectors.
- Finished in White, Black, Bronze, Painted Natural Aluminum or Clear Anodized.
- Application: Cove Lighting, Store Fixture, Display, Stack Lighting, Under Cabinet.
- Mounting: Surface (Wall/Ceiling) or Pendant Mount.
- Compliance: Built to comply with U.S. and Canadian safety standards.



ARRA
Compliant

OPTIONS

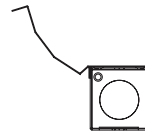
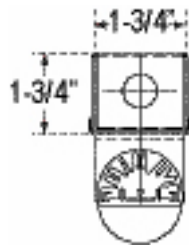

Asymmetrical Reflector
(ASSY)

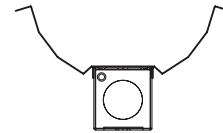

Symmetrical Reflector
(SYM)

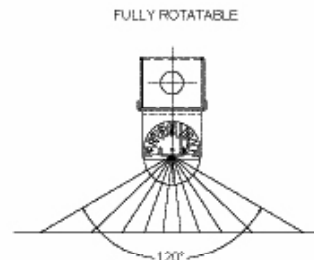
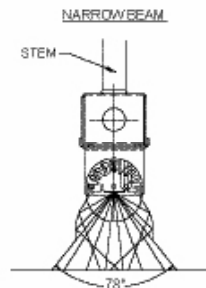
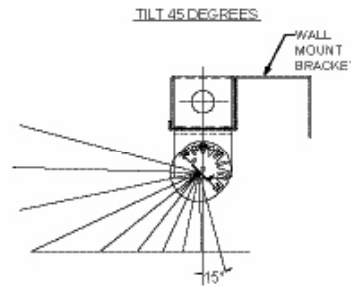
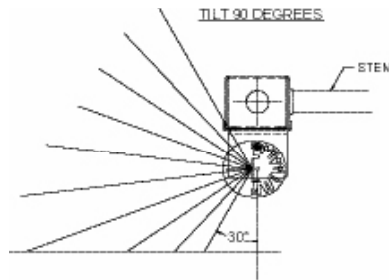

Sabre Series

Wall, Ceiling or Pendant Mount
Fully Dimmable LED Luminaire
INDOOR

ORDERING GUIDE: Series Mounting Wattage/Initial Lmns Color Temp Voltage: Primary/Emergency Finish Options

SERIES

SB = Sabre Linear Series

LENGTH	WATTAGE	LUMENS
12 = 12"	15W LED	1500
24 = 24"	25W LED	2500
44 = 44"	50W LED	5000

CL = Custom Length

MOUNTING

CM = Ceiling Mount

WM = Wall Mount (2" Wide Bracket is Standard)

PEND = Pendant Mounting (2 Stems Required)

STEM LENGTH

ST12 = 12" Stem Length (1/2" Dia.)

ST24 = 24" Stem Length (1/2" Dia.)

STCR = Custom Stem Length (Specify Length)

VOLTAGE

EBU = Universal Volt (120-277v)

COLOR TEMPERATURE

2.7K = ±2700K range (115 Initial LPW)

3K = ±3000K range (120 Initial LPW)

3.5K = ±3500K range (125 Initial LPW)

4K = ±4000K range (132 Initial LPW)

5K = ±5000K range (140 Initial LPW)

FINISH

BK = Black Finish

BZ = Bronze Finish

CA = Clear Anodized

CC = Custom Color Finish

PNA = Painted Natural Aluminum

WH = White Finish—Standard

OPTIONS

BL = Dual Circuit for High/Low Light Level

CB = Custom Brackets — Specify Width & Height

D7 = 0-10V low-voltage LED Dimming
(100-30% Standard, Consult Factory for Other)

D8 = LED Dimming: Forward Phase — Triac
(Consult Factory, available 3rd quarter of 2013)

MSE = Motion Sensor External for LED
Specify Finish: White (WH) or Bronze (BZ)

SG = 10KA Surge Protection for LED fixtures
(meets ANSI spec C62.41.2)

REFLECTOR

ASSY = Asymmetrical Reflector

SYM = Symmetrical Reflector

EMERGENCY BATTERY OPTIONS

No onsite Emergency Power (AC or DC) is provided

Specify Fixture Voltage: 120V or 277V Power Feed

A=120V or B=277V

LED Emergency Battery

REL61 = Remote: LED 12W, ± 720 Lms (lota)

REL67 = Remote, Cold Weather: LED 23W,
± 1290 Lms (lota)

LED EMERGENCY CIRCUIT[Ⓢ]

Onsite Generator Power (AC) or Battery Power (DC)

is provided via separate circuit to the fixture

EC1A = (1) 5W LED for Line Voltage (120VAC)

EC2A = (1) 5W LED for Line Voltage (277VAC)

EC3A = (2) 5W LED for Line Voltage (120VAC)

EC4A = (2) 5W LED for Line Voltage (277VAC)

EC1D = (1) 5W LED for Low Voltage (12VDC)

EC2D = (1) 5W LED for Low Voltage (24VDC)

EC3D = (2) 5W LED for Low Voltage (12VDC)

EC4D = (2) 5W LED for Low Voltage (24VDC)

NOTES:

- Ⓢ Consult Factory for other Voltage

PATENT PENDING