

Biscayne Series

Round Garage Luminaire

— 3 Diameter Sizes

LED

We reserve the right to revise the design or components of any product without notice.

CATALOG #		TYPE
PROJECT/LOCATION		
APPROVED BY		

SPECIFICATIONS

- DIFFUSER — 12", 15" or 22" Diameter Acrylic with Clear Dome Lens, approximately 85% light to driving area and 15% uplight. IES Type 5 is Standard. Optional Polycarbonate.
- DRIVER — Universal Voltage (120~277V) supplied as Standard. Dimming drivers available.
- GASKETING — High temperature, non-aging black EPDM and/or neoprene rubber concealed in Housing Pocket and Rear Wire Entrance Hole to protect against outside contaminants.
- HOUSING — Cast Aluminum. Finished in White Oven Baked Polyester Powder Coat.
- LENS FASTENERS — Stainless steel tamperproof screws (4) or Standard 8-32 to secure lens in place.
- LIGHT ENGINE — Energy Efficient Light Emitting Diode.
- MOUNTING — Direct Mount: Housing is supplied with (3) 5/16" Holes for 1/4" screws.
- SOCKET — 4 KV rated medium base porcelain with 16 gauge 200° C – SF-2 lead wires.
- COMPLIANCE — Built to comply with U.S. and Canadian safety standards. Suitable for wet locations.
- WARRANTY — 5 Years, Defects and Workmanship.



DIMENSIONS

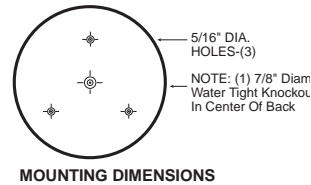
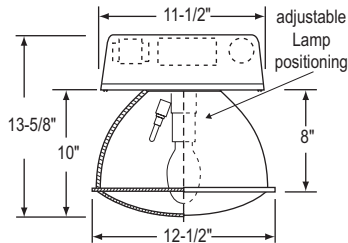

OPTIONS

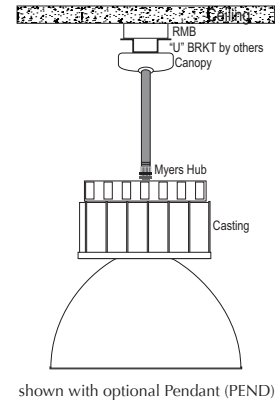
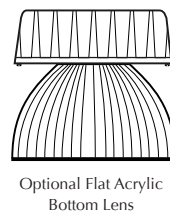
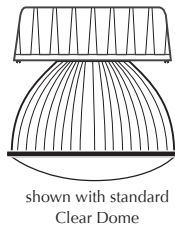

Biscayne Series

Round Garage Luminaire

— 3 Diameter Sizes

LED

LAMP TYPE/QTY/WATTAGE ¹			
Visit www.eclipselightinginc.com for available IES files			
Fixture	BC	BCXL	BCXL1
Dimensions	12" dia. x 13 $\frac{1}{2}$ "	15" dia. x 16 $\frac{1}{8}$ "	22" dia. x 16 $\frac{1}{8}$ "
Light Emitting Diode	LED	30w / 40w	40w / 60w / 100w
<i>*Consult Factory for CFL, HID, and Induction Lamping</i>			

ORDERING GUIDE:

Series	Lamp/Wattage	Color	Voltage	Finish	Options

SERIES

- BC = Biscayne Series (12")
- BCXL = Biscayne Series (16")
- BCXL1 = Biscayne Series (22")

LAMP TYPE/WATTAGE

Refer to Above Chart

PRIMARY VOLTAGE

- 120 = 120 Volts
- 277 = 277 Volts
- 347 = 347 Volts
- EBU = Universal Voltage (120 thru 277v)

LED COLOR TEMPERATURE

- 3K = \pm 3000K range
- 35K = \pm 3500K range
- 4K = \pm 4000K range
- 5K = \pm 5000K range

FINISH

- BK = Black Finish
- BZ = Bronze Finish
- CC = Custom Color (Consult Factory)
- WH = White Finish
- NAT = Natatorium finish-epoxy coated

OPTIONS

- CDR = Conical Dome Prismatic Lens
- FA = Flat Acrylic Bottom Lens
- FUS = Single Fusing
- FD = Frosted Diffuser
- DFUS = Double Fusing
- GTD = Generator Transfer Device (Bodine)
- HUB1 = 1/2" Myers Hub
- HUB2 = 3/4" Myers Hub
- ONB = Open Bottom
- PC = Prismatic Polycarbonate Diffuser
- PEND = Pendant Mount, 1/2" conduit entrance hole.
Specify Stem Length
- STC = Static Canopy
- SWC = Swivel Canopy
- QM = Quick Mount Bracket
- RMB = Rapid Mount Galvanized "J" Box (BC Only)
- INV = Inverter by Others

LED OPTIONS

- SG = 10KA Surge Protection for LED fixtures
(meets ANSI spec C62.41.2)

EMERGENCY OPTIONS²

No onsite Emergency Power (AC or DC) is provided
Specify Fixture Voltage: 120V or 277V Power Feed
A=120V or B=277V

LED Emergency Battery

Premium (Bodine/Iota)
REL63 = LED 23 Watt (Remote)

NOTES:

- ¹ Consult Factory with requests regarding lamp sources, including LED, color temp., wattages or voltages not shown.
- ² Consult Factory for additional Emergency Battery options not shown.
- ³ Max WHIP length with the REL provided by the factory is 8 feet.

Test Date: 02/10/2015

Tested in accordance with LM-79-80
The results contained in this summary report pertain only to the tested sample

Electrical Test Conditions						
Temp	Voltage	Current	Power	Power Factor	Frequency	Current THD
24.1°C/24.5°C	120.07	0.856	102.23	0.995	60.0	6.08%

Summary of Results	
Total Lumen Output	6,586.0
Efficacy (lm/W)	64.42
Maximum Candela	4,338.7 (@315°H; 25°V)
CRI	90.7
CCT	4344 K
Duv	0.00320

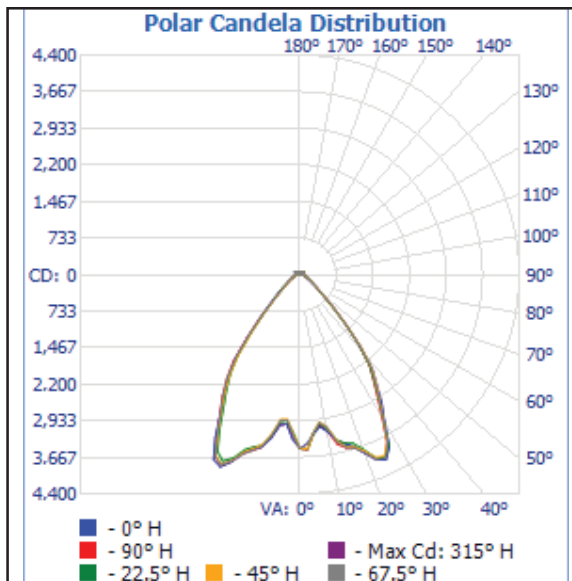

Chromaticity Coordinates	
Chromaticity (x)	0.3679
Chromaticity (y)	0.3753
Chromaticity (u)	0.2175
Chromaticity (v)	0.3327
Chromaticity (u')	0.2175
Chromaticity (v')	0.4991

Zonal Lumen Summary		
Zone	Lumens	%Luminaire
0-60	5,806.5	89.0
60-90	313.6	4.8
0-90	6,120.1	93.0
90-180	401.1	6.2
0-180	6,521.2	100.0

Cone of Light Tabulation		
Mounting Height (Ft)	Footcandles at Nadir	Diameter (Ft)
3.3	314.06	4.6
6.7	78.51	9.2
10.0	34.90	13.7
13.3	19.63	18.3
16.7	12.56	22.9
20.0	8.72	27.5

