

# Arden 4 Series

## AREA/PARKING/INDUSTRIAL

TUNNEL UNDERPASS LUMINAIRE  
Ceiling & Wall Mount

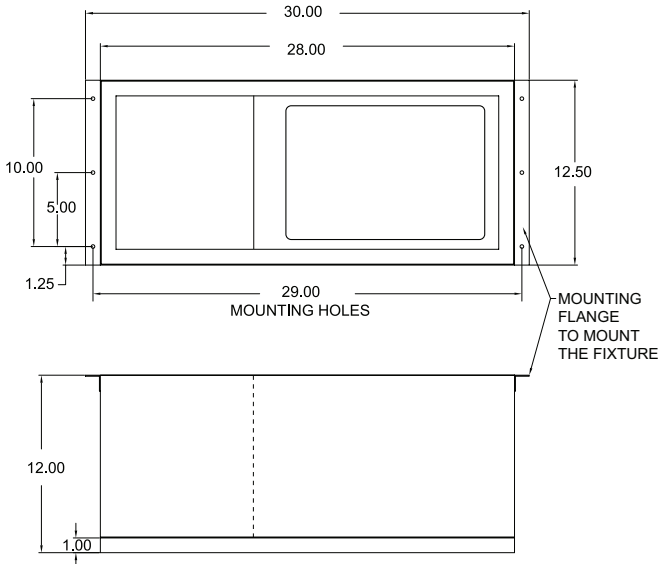

END VIEW

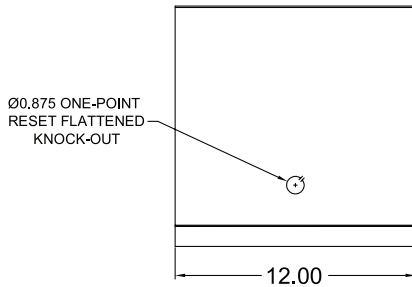

We reserve the right to revise the design or components of any product without notice.

CATALOG #		TYPE
PROJECT/LOCATION		
APPROVED BY		

### SPECIFICATIONS

- HOUSING — Heavy gauge (16GA) 316 Stainless Steel Construction (SS1), die formed and seam welded to provide a sealed enclosure with vibration resistant construction suitable for roadway underpass lighting. Conduit access and mounting provided to prevent water ingress in adverse environmental conditions.
- REFLECTOR — Asymmetrical design to provide accurate efficient light output.
- LENS — Crystal clear tempered glass 1/4" thick to provide optimal light transmission while protecting the optical chamber from contaminant's plus vandal resistance.
- GASKETING — Heavy duty closed cell silicone material for maximum sealing capabilities in varied ambient temperatures and environmental conditions. Silicone gasket material seals the lens to frame and frame to housing
- LENS FRAME FASTENERS — The removable stainless steel frame is hinged at one end with stainless steel cam latches to secure the frame assembly to the housing. No tools are required to open the frame and gain access for maintenance
- SOCKET — 4KV Pulse rated socket
- LAMP — MOGUL High Pressure Sodium (S51) or Metal Halide Optional BY OTHERS
- BALLAST — CWA quad volt standard —120 and 277 Volt High Power Factor or Quad Volt optionally available. Pulse Start Metal Halide.
- REMOVABLE BALLAST TRAY— 12 AWG 3003-H14 aluminum, 0.125 inches (3.175mm) mounted on a removable hinge and stainless steel latch to facilitate quick tool-less removal for ease of servicing ballast. There are provisions for dual fuse holders on the tray front access along with a wiring diagram viewable from any angle when the door frame is open.
- ETL LISTED. Suitable for wet locations & IP65 Standard

LAMP TYPE/QTY/WATTAGE		
Lamp/Fixture		ARDEN
Metal Halide	MH	100, 150, 175, 200 or 250 Watt
High Pressure Sodium Mogul Base (ED18)	HPS	100, 150, 200, 250 or 400 Watt
Induction Fluorescent <sup>1</sup> Osram	ICE	100 or 150 Watt
Induction Fluorescent <sup>1</sup> Philips	QL	85 or 165 Watt
Ceramic Metal Halide Philips - CosmoPolis™ (T6)	CMHC	90 or 140w (277V Standard)
Ceramic Metal Halide Philips - Elite™ - Dimmable (T9)	CMHE	210 or 315w (277V Standard)

### ORDERING GUIDE:

SERIES	OPTICAL	LAMP TYPE/QTY/WATT	VOLTAGE/POWER FACTOR	FINISH	OPTIONS
--------	---------	--------------------	----------------------	--------	---------

#### NOTES:

- <sup>1</sup> Induction lamp system requires outboard generator compartment (Included).

SERIES  
AD4 = Arden 4 Series

LAMP TYPE/QUANTITY/WATTAGE  
Refer to Chart Above

OPTICAL  
A = IES Type III  
B = IES Type II

VOLTAGE  
120 = 120 Volts HPF  
240 = 240 Volts MAG REG  
277 = 277 Volts HPF  
QV = CWA Quad Volt (120, 208, 240 or 277V)  
TV = 120, 277, 347

POWER FACTOR  
IND = HF Generator - Induction

OPTIONS  
AL = Aluminum Construction  
EB = Electronic Ballast for MH  
FUS = Panel Mount Fuse & Fuse Holder  
QM = Quick Mount  
SS2 = 16GA 304 Stainless Steel (2B), die formed and seam welded  
WM = Wall Mount