

Sonic

Indoor Drum Fixture with Solid Shield Trim Ceiling or Wall Family—Damp Location

We reserve the right to revise the design or components of any product without notice.

CATALOG #		TYPE
PROJECT/LOCATION		
APPROVED BY		

SPECIFICATIONS

- DRIVER — Universal Voltage 120/277v Electronic Driver is standard for LED.
- DIFFUSER — Opal Acrylic Standard. Optional Polycarbonate.
- DECORATIVE TRIM — Heavy Gauge Aluminum with Solid Shield Trim.
- EMERGENCY — LED — Remote Emergency Battery.
- FINISH — Heavy Gauge Aluminum Trim. White Polyurethane Powder Coated Finish is Standard.
- HARDWARE INCLUDED — (1) J Boxstrap, (1) Nipple, (1) Cap Nut.
- LIGHT ENGINE — Energy Efficient Light Emitting Diode (LED).
- MOUNTING — Center Access Hole For Mounting To A “J” Box.
- PAN — White Polyurethane Finished Aluminum.
- SCREWS — Brass Thumb Screw.
- COMPLIANCE — Built to comply with U.S. and Canadian safety standards. Suitable for damp locations. **Made in USA / Buy America Compliant / Buy American Act.**



ORDERING INFO

Series	Wattage	CCT	CRI	Voltage	Finish	Mounting	Options
ORDERING GUIDE:							

SERIES

SC = Sonic Drum (15¼" Dia.)

WATTAGE

LED25 = 25 Watt LED

LED COLOR TEMPERATURE (CCT)

- 3K = ±3000K range
- 35K = ±3500K range
- 4K = ±4000K range
- 5K = ±5000K range

COLOR RENDERING INDEX (CRI)

80CRI = 80 Color Rendering Index — STANDARD
90CRI = 90 Color Rendering Index

VOLTAGE

347 = 347 Volts (Consult Factory)
UNV = Universal Voltage (120-277V) Driver
2UNV = Two 120/277V Electronic Drivers

FINISH

WH = White Finish — STANDARD

~or~

PREMIUM UPCHARGE FINISH

- BK = Black Finish
- BZ = Bronze Finish
- CC = Custom Color (Visit www.ralcolor.com)
— Provide RAL# or Make-to-Match Color Chip
- PNA = Painted Natural Aluminum
- SGR = Silver Gray

MOUNTING

- SM = Surface Mount — STANDARD
- AAC = Adjustable Aircraft Cable (Up to 120")
- PEND = Pendant Mount (12" Stem)
— For Custom Stem Specify Length
— Includes Canopy Swivel Kit (45°)

DIMMING OPTIONS

- Note: 0-10V 100%-30% is Standard
- D7A = 0-10VDC LED Dimming Driver (100-10%)
- D7B = 0-10VDC LED Dimming Driver (100-1%)

CONTROL OPTIONS

- Note: See Accessory Options for Required Remote Controller
- OCC = Occupancy Sensing | Motion Sensor Integral[Ⓜ]
— Microwave / Single Feed / 120/277V Only
— Standby Dim Level Presets: ON/OFF (0%/100%)
- BLD = Bi-Level Dimming | Motion Sensor Integral[Ⓜ]
— Microwave / Single Feed / 120/277V Only
— Standby Dim Level Presets:
10% / 20% / 30% (Standard) / 50%
— Note: BLD not compatible with REL Options
- BLS = Bi-Level Switching — Using 2 Drivers (2UNV)

MISC OPTIONS

- FUS = Single Fusing
- DFUS = Double Fusing
- SG = 10KA Surge Protection (ANSI spec: C62.41.2)
- TP = Tamperproof Screws
- PC = Polycarbonate Diffuser

EMERGENCY / BATTERY OPTIONS [Ⓜ] [Ⓟ]

No onsite Emergency Power (AC or DC) is provided

- REL-GTD1 = Generator Transfer Device (Signify)
- REL-GTD2 = Generator Transfer Device (LGTD)
— Shunt Relay w/Fire Alarm Override Input

Meets California Energy Commission Title 20:
(CEC-400-2014-009-CMF) Efficiency Standards

- EL4W = Integral LED 4 Watt
- EL8W = Integral LED 8 Watt

- REL4W = Remote LED 4 Watt
- REL8W = Remote LED 8 Watt
- REL16W = Remote LED 16 Watt

Cold Weather Emergency Batteries:

Operating Temp: -20°C thru 50°C
NON-CEC Compliant

- REL10W-CW = Remote LED 10 Watt (Cold Weather)

ACCESSORY OPTIONS (order as a separate line)

- 9002 = Tamperproof Screwdriver
- REMT = Remote Controller for Sensor Options

NOTES:

- [Ⓜ] Max mounting height of fixture is 10' (10 feet).
- [Ⓟ] Max WHIP length with the REL provided by the factory is 8 feet.
- [Ⓠ] Final selection of the Battery Pack under discretion of Factory.

DIMENSIONS

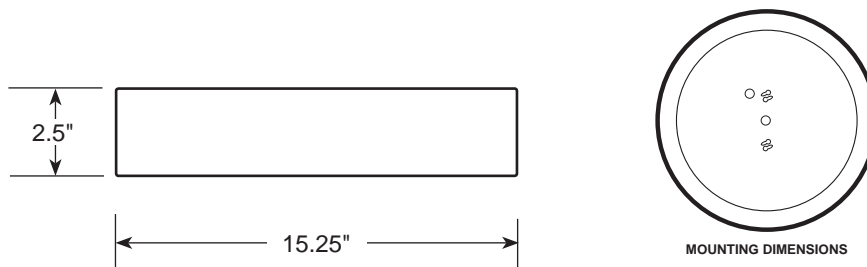

Sonic

*Indoor Drum Fixture
with Solid Shield Trim
Ceiling or Wall Family – Damp Location*

We reserve the right to revise the design or components of any product without notice.

CATALOG #		TYPE
PROJECT/LOCATION		
APPROVED BY		

AIRCRAFT CABLE MOUNTING

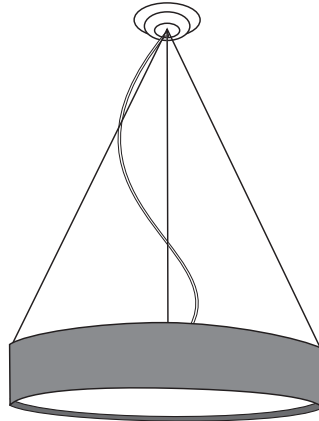

Adjustable Aircraft Cable (AAC)
Up to 120"

PENDANT CANOPY SWIVEL KIT

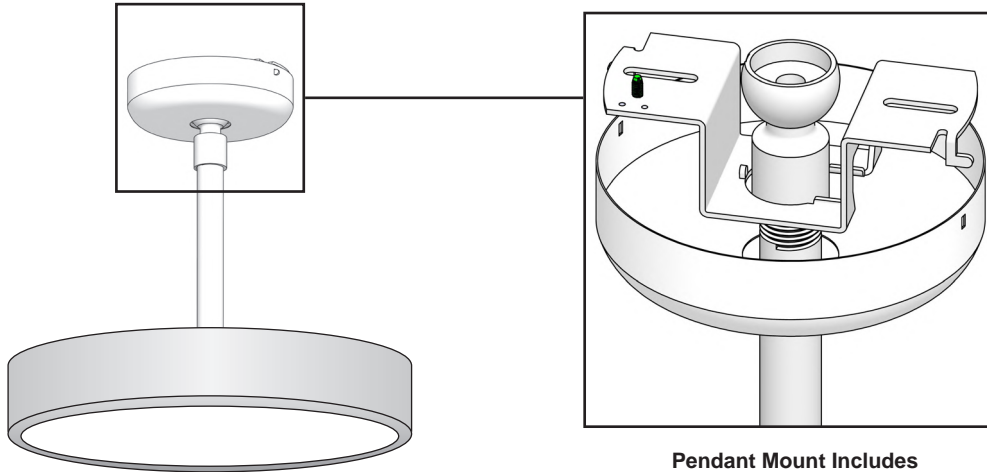

**Pendant Mount Includes
Canopy Swivel Kit**