

# Clark Pendant

## Round Pendant Mount Luminaire Selectable Wattage & CCT Indoor Ceiling

We reserve the right to revise the design or components of any product without notice.

CATALOG #		TYPE
PROJECT/LOCATION		
APPROVED BY		

### SPECIFICATIONS

- DIFFUSER — Opal white polycarbonate is standard.
- DRIVER — Universal Volt (120-277V) Electronic Driver. 0-10V Low Voltage Dimming (100% to 30%) is Standard.
- FINISH — Polyester powder coat white Standard. Optional Custom Colors.
- GASKETING — High temp, non-aging black EPDM gasketed seal. Seals diffuser to cast housing to protect against outside contaminants.
- HOUSING — Spun aluminum housing with built-in heatsinks for thermal management.
- MOUNTING — Pendant Mount with 12" Stem and Canopy. 1/2" NPT galvanized and powder coated, 12" long stem standard. Optional lengths available.
- COMPLIANCE — Built to comply with U.S. and Canadian Safety Standards.

**Build America/Buy America Act (BABA) and Buy American Act (BAA) compliant.**



### ORDERING INFO

Series	Mounting	Wattage	CCT	Voltage	Finish	Options

#### SERIES

CK-P = Clark Pendant Series

#### MOUNTING

ST12 = 12" Stem (1/2" Dia.) w/ Static Canopy  
SW12 = 12" Stem (1/2" Dia.) w/ Swivel Canopy

#### WATTAGE

Refer to Below Chart for Wattage / Lumen Output  
SLED = Selectable LED Wattages: 21W | 28W

#### COLOR TEMPERATURE (CCT)

SCCT = Selectable CCT: 3000K | 3500K | 4000K | 5000K

#### VOLTAGE

UNV = Universal Volt (120-277v) Electronic Driver

#### STANDARD FINISH

BK = Black Finish  
BZ = Bronze Finish  
PNA = Painted Natural Aluminum  
WH = White Finish Standard

#### PREMIUM UPCHARGE FINISH

CC = Custom Color (Visit [www.ralcolor.com](http://www.ralcolor.com))  
— Provide RAL# or Make-to-Match Color Chip  
+NAT = Conformal Coating - Light Engine Only

#### CONTROL OPTIONS

Sensor Control (Sensor Integral to Fixture)  
OCC = Occupancy Sensing | Motion Sensor Integral<sup>20</sup>  
— Microwave / Single Feed / 120/277V Only  
— Standby Dim Level Presets: ON/OFF (0%/100%)

#### MISC OPTIONS

FUS = Single Fusing

#### ACCESSORY OPTIONS (order as a separate line)

9002 = Tamperproof Screwdriver  
REMT = Remote Controller for Sensor Options

#### NOTES:

<sup>20</sup> Max mounting height of fixture is 18' (18 feet)

### WATTAGE / LUMEN INFORMATION

Wattage	CCT	Lumens	Efficacy
21 Watt	3000K	3,100 Lumens	148 lm/W
	3500K	3,125 Lumens	149 lm/W
	4000K	3,150 Lumens	150 lm/W
	5000K	3,200 Lumens	152 lm/W
28 Watt	3000K	4,100 Lumens	144 lm/W
	3500K	4,125 Lumens	145 lm/W
	4000K	4,150 Lumens	146 lm/W
	5000K	4,200 Lumens	147 lm/W

# Clark Pendant

*Round Pendant Mount Luminaire*  
*Selectable Wattage & CCT*  
*Indoor Ceiling*

We reserve the right to revise the design or components of any product without notice.

CATALOG #		TYPE
PROJECT/LOCATION		
APPROVED BY		

## MOUNTING DETAILS

## DIMENSIONS

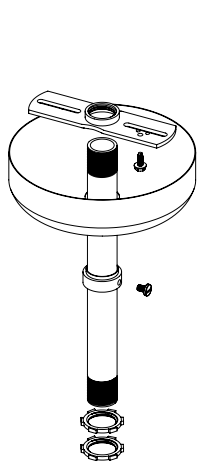

**ST12** = 12" Stem (1/2" Dia.)  
w/ Static Canopy

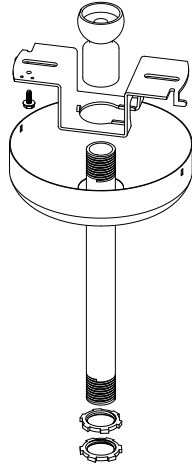

**SW12** = 12" Stem (1/2" Dia.)  
w/ Swivel Canopy

